

THIS DRAWING IS TO BE USED ONLY FOR THE PURPOSE OF ISSUE THAT IT WAS ISSUED FOR AND IS SUBJECT TO AMENDMENT

- LEGEND**
- Order Limits
 - Electricity Generating Station (Work No. 1) - Main Development Area
 - Emission Stacks (Work No. 1A)
 - Administration Block (Work No. 1B)
 - Utility Connections (Work No. 2)
 - Landscaping and Biodiversity (Work No. 3)
 - Site Access (Work No. 4)
 - Temporary Construction Laydown Areas (Work No. 5)

Copyright
 Reproduced from Ordnance Survey digital map data
 © Crown copyright 2020. All rights reserved.
 Licence number 0100031673.



FICHTNER
 CONSULTING ENGINEERS LIMITED
 Kingsgate, Wellington Road North,
 Stockport, Cheshire, SK4 1LW, UK
 Tel: 0161 476 0032
 Website: www.fichtner.co.uk

Purpose of Issue
ENVIRONMENTAL STATEMENT

Client
EP WASTE MANAGEMENT LTD

Project Title
SOUTH HUMBER BANK ENERGY CENTRE DCO

Application Document Ref
PARTS OF THE SITE (ORDER LIMITS AND WORK NUMBERS)

| | | | |
|--|---------------|-----------------------|--------------------|
| Drawn LC | Checked LK | Approved KC | Date 07/04/2020 |
| AECOM Internal Project No. 60580855 | | Scale @ A3 1:3,000 | |

THIS DOCUMENT HAS BEEN PREPARED PURSUANT TO AND SUBJECT TO THE TERMS OF AECOM'S APPOINTMENT BY ITS CLIENT. AECOM ACCEPTS NO LIABILITY FOR ANY USE OF THIS DOCUMENT OTHER THAN BY ITS ORIGINAL CLIENT OR FOLLOWING AECOM'S EXPRESS AGREEMENT TO SUCH USE, AND ONLY FOR THE PURPOSES FOR WHICH IT WAS PREPARED AND PROVIDED.

AECOM
 One Trinity Gardens
 Quayside
 Newcastle upon Tyne
 NE1 2PF
 T+44 (0)191 224 6500
 www.aecom.com

Drawing Ref
FIGURE 3.1

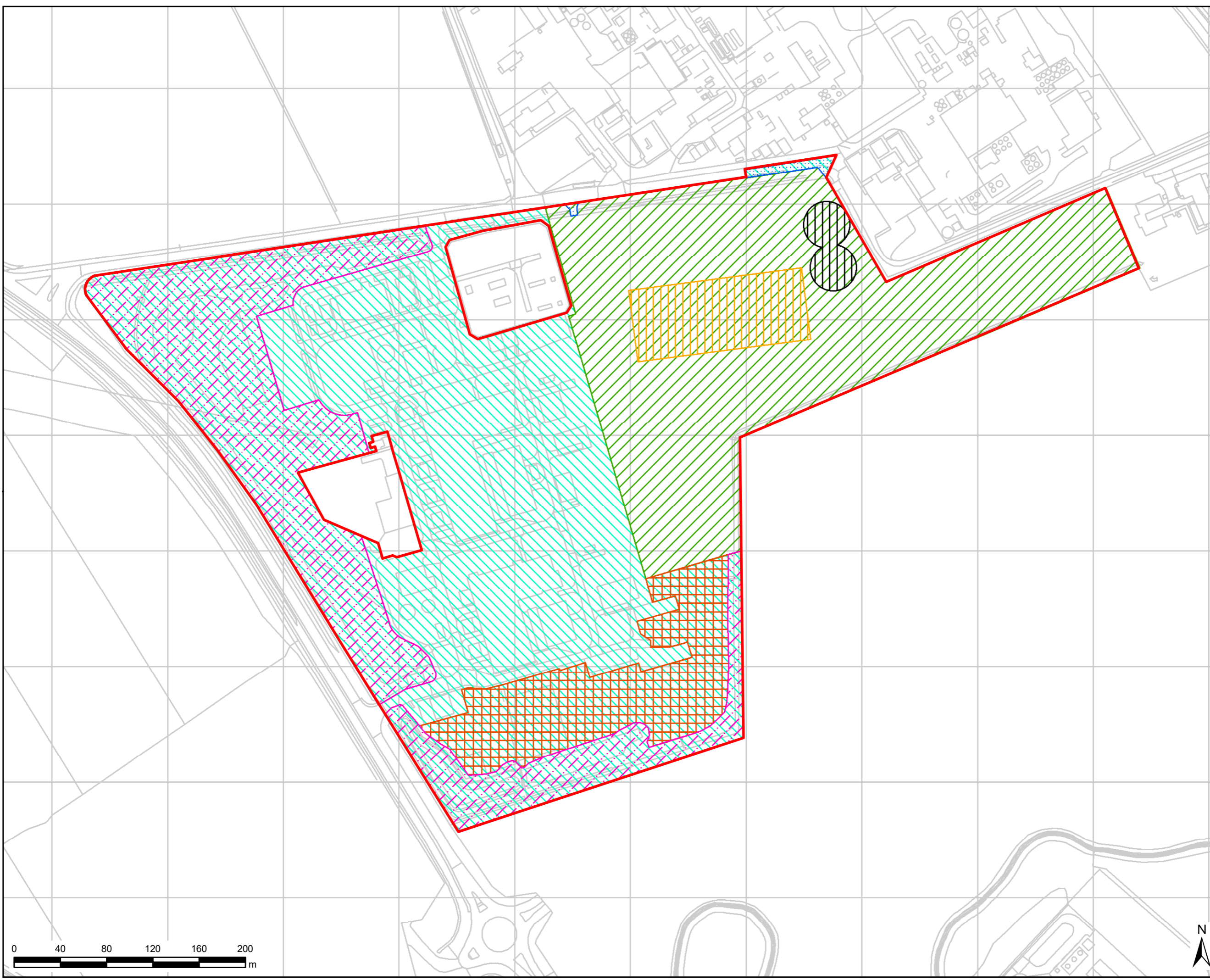

File Name: \\ukls2pifsrv001\LE_Projects\Newproj\60580855 - Project\Kala\aka SHBECAD_C\SI\Workspace\IA Drawings 2020\3_1_Parts_of_the_Site.mxd