

# Historical Mapping Legends

## Ordnance Survey County Series 1:10,560

	Gravel Pit		Sand Pit		Other Pits
	Quarry		Shingle		Orchard
	Osiers		Reeds		Marsh
	Mixed Wood		Deciduous		Brushwood
	Fir		Furze		Rough Pasture
	Arrow denotes flow of water		Trigonometrical Station		
	Site of Antiquities		Bench Mark		
	Pump, Guide Post, Signal Post		Well, Spring, Boundary Post		
	Surface Level				
	Sketched Contour		Instrumental Contour		
	Main Roads		Minor Roads		
	Sunken Road		Raised Road		
	Road over Railway		Railway over River		
	Railway over Road		Level Crossing		
	Road over River or Canal		Road over Stream		
	Road over Stream				
	County Boundary (Geographical)				
	County & Civil Parish Boundary				
	Administrative County & Civil Parish Boundary				
	County Borough Boundary (England)				
	County Burgh Boundary (Scotland)				
	Rural District Boundary				
	Civil Parish Boundary				

## Ordnance Survey Plan 1:10,000

	Chalk Pit, Clay Pit or Quarry		Gravel Pit
	Sand Pit		Disused Pit or Quarry
	Refuse or Slag Heap		Lake, Loch or Pond
	Dunes		Boulders
	Coniferous Trees		Non-Coniferous Trees
	Orchard		Scrub
	Bracken		Heath
	Marsh		Reeds
	Building		Glasshouse
	Sloping Masonry		Pylon
	Cutting		Embankment
	Road Under		Road Over
	Level Crossing		Foot Bridge
	Standard Gauge Multiple Track		Standard Gauge Single Track
	Siding, Tramway or Mineral Line		Narrow Gauge
	Geographical County		Administrative County, County Borough or County of City
	Municipal Borough, Urban or Rural District, Burgh or District Council		Borough, Burgh or County Constituency
	Civil Parish		
	Boundary Post or Stone		Police Station
	Church		Post Office
	Club House		Public Convenience
	Fire Engine Station		Public House
	Foot Bridge		Signal Box
	Fountain		Spring
	Guide Post		Telephone Call Box
	Mile Post		Telephone Call Post
	Mile Stone		Well

## 1:10,000 Raster Mapping

	Gravel Pit		Refuse tip or slag heap
	Rock		Rock (scattered)
	Boulders		Boulders (scattered)
	Shingle		Mud
	Sand		Sand Pit
	Slopes		Top of cliff
	General detail		Underground detail
	Overhead detail		Narrow gauge railway
	Multi-track railway		Single track railway
	County boundary (England only)		Civil, parish or community boundary
	District, Unitary, Metropolitan, London Borough boundary		Constituency boundary
	Area of wooded vegetation		Non-coniferous trees
	Non-coniferous trees (scattered)		Coniferous trees
	Coniferous trees (scattered)		Positioned tree
	Orchard		Coppice or Osiers
	Rough Grassland		Heath
	Scrub		Marsh, Salt Marsh or Reeds
	Water feature		Flow arrows
	Mean high water (springs)		Mean low water (springs)
	Telephone line (where shown)		Electricity transmission line (with poles)
	Bench mark (where shown)		Triangulation station
	Point feature (e.g. Guide Post or Mile Stone)		Pylon, flare stack or lighting tower
	Site of (antiquity)		Glasshouse
	General Building		Important Building

# Envirocheck®

LANDMARK INFORMATION GROUP®

## Historical Mapping & Photography included:

Mapping Type	Scale	Date	Pg
Yorkshire	1:10,560	1855	3
Lincolnshire	1:10,560	1887 - 1888	4
Yorkshire	1:10,560	1892	5
Lincolnshire	1:10,560	1908	6
Yorkshire	1:10,560	1910	7
Lincolnshire	1:10,560	1932 - 1933	8
Lincolnshire	1:10,560	1938 - 1951	9
Yorkshire	1:10,560	1951	10
Yorkshire	1:10,560	1951	11
Lincolnshire	1:10,560	1951	12
Ordnance Survey Plan	1:10,000	1956	13
Ordnance Survey Plan	1:10,000	1966	14
Ordnance Survey Plan	1:10,000	1968	15
Ordnance Survey Plan	1:10,000	1982	16
Grimsby	1:10,000	1986	17
Ordnance Survey Plan	1:10,000	1989	18
10K Raster Mapping	1:10,000	2000	19
10K Raster Mapping	1:10,000	2006	20
VectorMap Local	1:10,000	2018	21

## Historical Map - Slice A

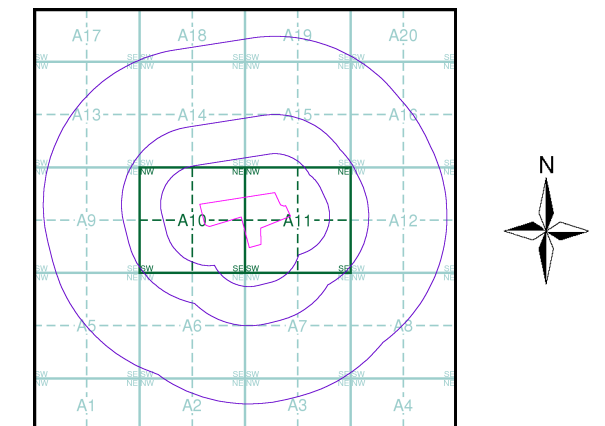

## Order Details

Order Number: 169911223\_1\_1  
Customer Ref: RCH080  
National Grid Reference: 522990, 413380  
Slice: A  
Site Area (Ha): 9.64  
Search Buffer (m): 1000

## Site Details

B O C Ltd, Hobson Way, Stallingborough, GRIMSBY, DN41 8DZ

**Landmark®**  
INFORMATION GROUP

Tel: 0844 844 9952  
Fax: 0844 844 9951  
Web: www.envirocheck.co.uk

Russian Military Mapping Legends

1:5,000 and 1:10,000 mapping

a. Not drawn to scale    b. Drawn to scale

Government and Administrative Buildings    Military and Industrial Buildings

Military and Communication Areas    Subway Entrance

Fireproof Building    Prominent Fireproof Building

Non-fireproof Building    Non-fireproof Building (non-dwelling)

Factory, mill, and flour mill, with chimneys    Factory, mill, and flour mill, without chimneys

Power Station, drawn to scale    Hydroelectric Power Station

Radio Station, drawn to scale    Telephone Station, drawn to scale

Abandoned Open-pit Mine or Quarry    Open-pit Salt Mine

Pit    Oil Deposit or Well    Oil Seepage

Tailings Pile    Fuel Storage Tanks    Natural Gas Tank

Bench Mark    Drill Hole    Burial Mound    Triangulation Point on Burial Mound

Single-track Railroad    Small Bridge    Double-track Railroad and Station Building

Coniferous Forest    Deciduous Forest    Mixed Forest

Lawns    Citrus Orchard    Wet Ground    Scattered Vegetation

243.8    Values for prominent elevations

186.0    Numbers for spot elevations, depth soundings, contour lines, etc.

0.2    Velocity of the current, width of river bed, depth of river

180 180    Fractional terms: length and capacity of bridges; depth of fords and condition of the river bottom; height of forest and the diameter of trees

Russian Alphabet (For reference and phonetic interpretation of map text)

А а (A)	З з (Z)	П п (P)	Ч ч (CH)
Б б (B)	И и (I)	Р р (R)	Ш ш (SH)
В в (V)	Й й (Y)	С с (S)	Щ щ (SHCH)
Г г (G)	К к (K)	Т т (T)	Ъ (-)
Д д (D)	Л л (L)	У у (U)	Ы (Y)
Е е (E)	М м (M)	Ф ф (F)	Ь (')
Ё ё (YO)	Н н (N)	Х х (KH)	Э э (E)
Ж ж (ZH)	О о (O)	Ц ц (TS)	Ю ю (YU or IU)
			Я я (YA or IA)

1:25,000 mapping

a. Not drawn to scale    b. Drawn to scale

Government and Administrative Buildings    Military and Industrial Buildings

Military and Communication Areas    Subway Entrance

Partly Demolished Buildings    Demolished Buildings

Built-Up Area with Fireproof Buildings Predominant    Built-Up Area with Non-Fireproof Buildings Predominant

Individual Fireproof Building    Prominent Industrial Building

Individual Dwelling, Fireproof    Ruins of an Individual Dwelling

Factory or Mill Chimney    Factory or Mill with Chimney    Factory or Mill without Chimney    Mine or Open Pit Mine

Operating Shaft or Mine    Non-Operating Shaft or Mine    Salt Mine    Tailings Pile

Pit    Stone Quarry    Gas Pump or Service Station    Fuel Storage or Natural Gas Tank

Oil or Natural Gas Derrick    Small Hydroelectric Power Station    Power Station    Transformer Station

Cemetery    Burial Mound (height in metres)    Triangulation Point on Burial Mound    Triangulation Point

Bench Mark    Bench Mark (monumented)    Telegraph Office    Telephone Station

Radio Station    Radio Tower    Airfield or Seaplane Base    Landing Strip

Telegraph/Telephone Lines    Main Highway    Highway under Construction    Improved Dirt Road (former truck road)

Small Bridge    Pipe (Culvert)    Tunnel    Dismantled Railroad

Double-track Railroad with First Class Station    Railroad Under Construction

Shore Embankment    River or Ditch with Embankment    Direction and velocity of current    Water Gauge    Water Level Mark

Well    Water Reservoir or Rain Water Pit    Spring    Isobath with value

Heavy (Index) Contour Line    Contour Line and Value    Half Contour Line    Spot Elevation Value

Coniferous    Deciduous    Mixed    Scrub

Key to Numbers on Mapping

TA21SW\_Grimsby

No.	Description
6	Factory (Use Unknown)

Envirocheck®

LANDMARK INFORMATION GROUP®

Historical Mapping & Photography included:

Mapping Type	Scale	Date	Pg
Yorkshire	1:10,560	1855	3
Lincolnshire	1:10,560	1887 - 1888	4
Yorkshire	1:10,560	1892	5
Lincolnshire	1:10,560	1908	6
Yorkshire	1:10,560	1910	7
Lincolnshire	1:10,560	1932 - 1933	8
Lincolnshire	1:10,560	1938 - 1951	9
Yorkshire	1:10,560	1951	10
Yorkshire	1:10,560	1951	11
Lincolnshire	1:10,560	1951	12
Ordnance Survey Plan	1:10,000	1956	13
Ordnance Survey Plan	1:10,000	1966	14
Ordnance Survey Plan	1:10,000	1968	15
Ordnance Survey Plan	1:10,000	1982	16
Grimsby	1:10,000	1986	17
Ordnance Survey Plan	1:10,000	1989	18
10K Raster Mapping	1:10,000	2000	19
10K Raster Mapping	1:10,000	2006	20
VectorMap Local	1:10,000	2018	21

Russian Map - Slice A

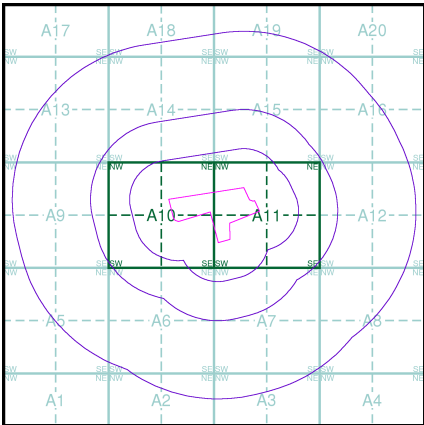

Order Details

Order Number: 169911223\_1\_1  
Customer Ref: RCH080  
National Grid Reference: 522990, 413380  
Slice: A  
Site Area (Ha): 9.64  
Search Buffer (m): 1000

Site Details

B O C Ltd, Hobson Way, Stallingborough, GRIMSBY, DN41 8DZ

Landmark®  
INFORMATION GROUP

Tel: 0844 844 9952  
Fax: 0844 844 9951  
Web: www.envirocheck.co.uk

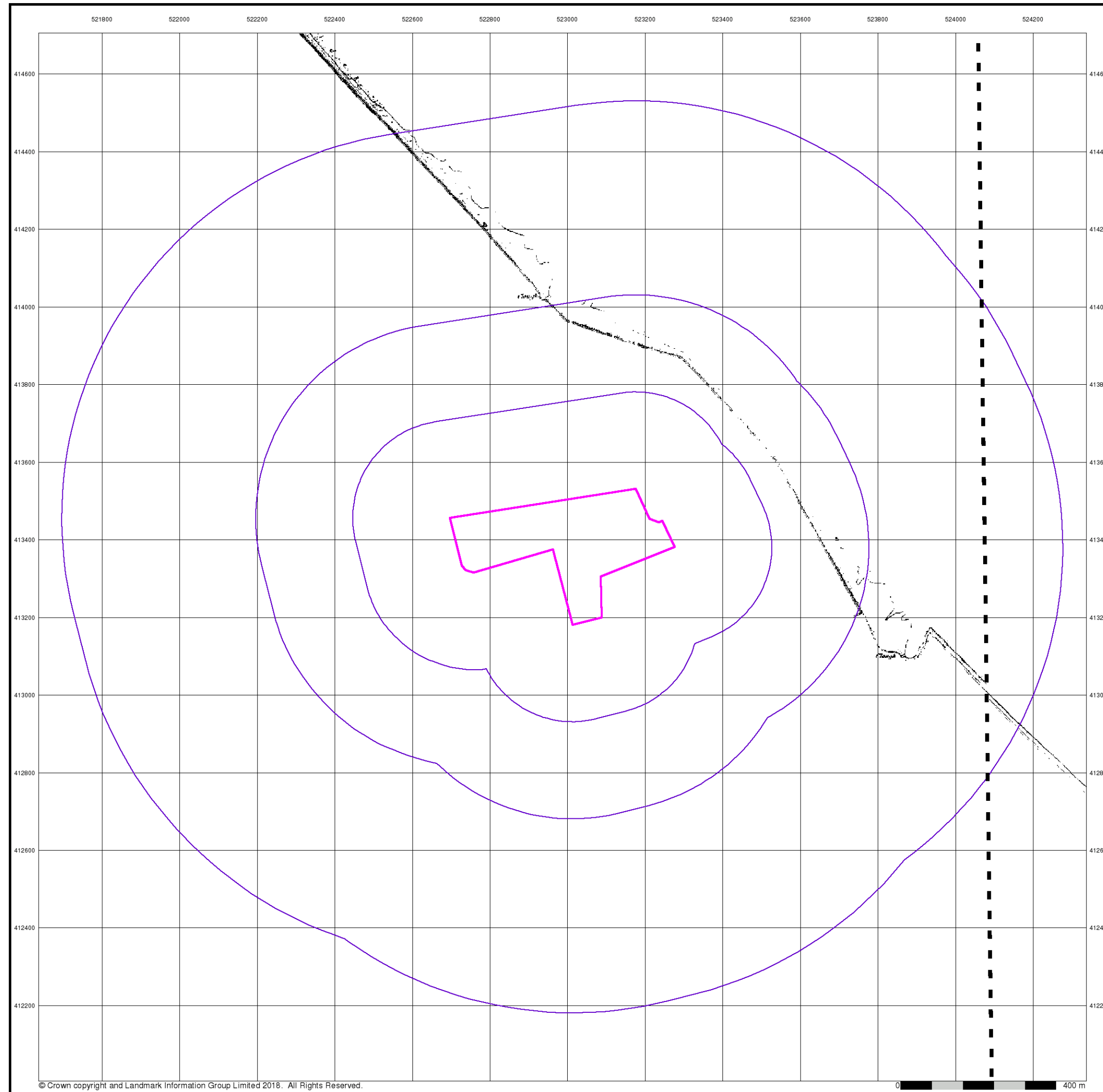

© Crown copyright and Landmark Information Group Limited 2018. All Rights Reserved.

0 400 m

# Envirocheck®

LANDMARK INFORMATION GROUP®

Yorkshire

Published 1855

Source map scale - 1:10,560

The historical maps shown were reproduced from maps predominantly held at the scale adopted for England, Wales and Scotland in the 1840's. In 1854 the 1:2,500 scale was adopted for mapping urban areas; these maps were used to update the 1:10,560 maps. The published date given therefore is often some years later than the surveyed date. Before 1938, all OS maps were based on the Cassini Projection, with independent surveys of a single county or group of counties, giving rise to significant inaccuracies in outlying areas. In the late 1940's, a Provisional Edition was produced, which updated the 1:10,560 mapping from a number of sources. The maps appear unfinished - with all military camps and other strategic sites removed. These maps were initially overprinted with the National Grid. In 1970, the first 1:10,000 maps were produced using the Transverse Mercator Projection. The revision process continued until recently, with new editions appearing every 10 years or so for urban areas.

## Map Name(s) and Date(s)

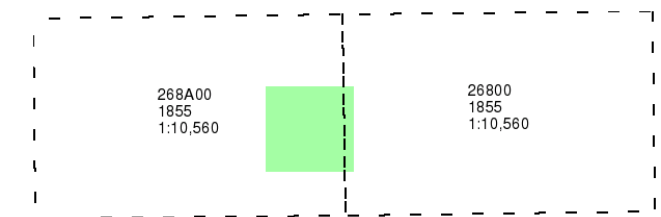

## Historical Map - Slice A

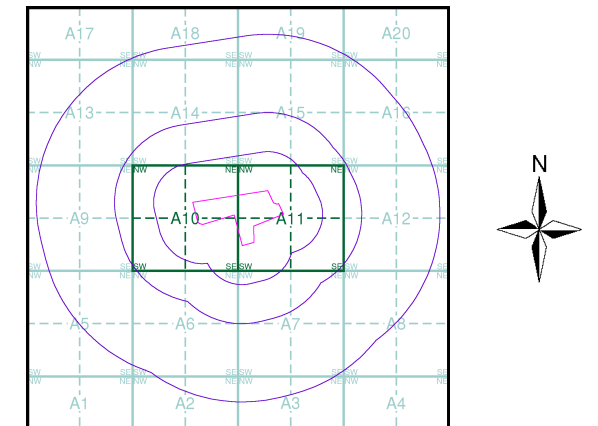

## Order Details

Order Number: 169911223\_1\_1  
Customer Ref: RCH080  
National Grid Reference: 522990, 413380  
Slice: A  
Site Area (Ha): 9.64  
Search Buffer (m): 1000

## Site Details

B O C Ltd, Hobson Way, Stallingborough, GRIMSBY, DN41 8DZ

Landmark®  
INFORMATION GROUP

Tel: 0844 844 9952  
Fax: 0844 844 9951  
Web: www.envirocheck.co.uk

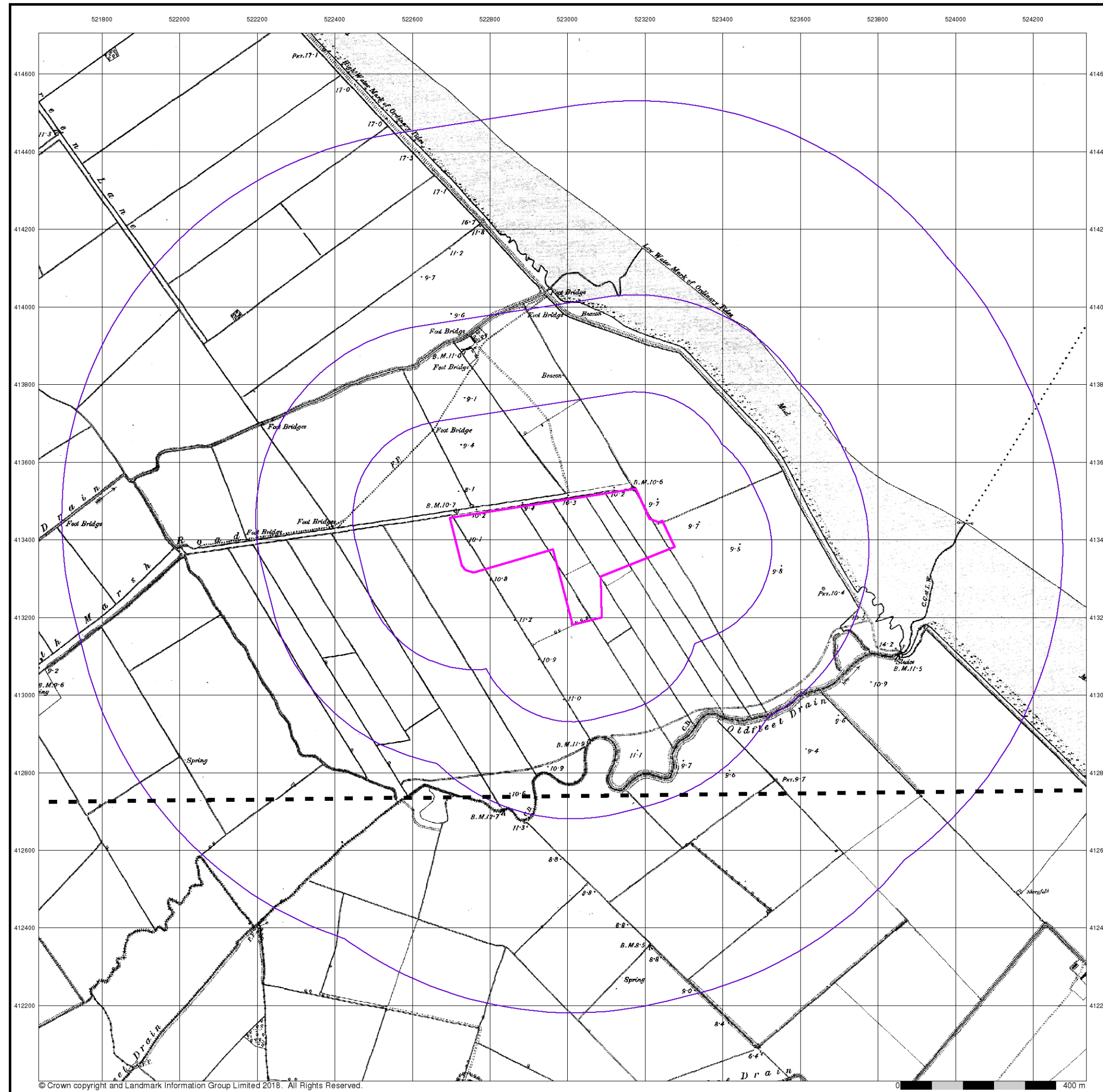

## Lincolnshire

Published 1887 - 1888

Source map scale - 1:10,560

The historical maps shown were reproduced from maps predominantly held at the scale adopted for England, Wales and Scotland in the 1840's. In 1854 the 1:2,500 scale was adopted for mapping urban areas; these maps were used to update the 1:10,560 maps. The published date given therefore is often some years later than the surveyed date. Before 1938, all OS maps were based on the Cassini Projection, with independent surveys of a single county or group of counties, giving rise to significant inaccuracies in outlying areas. In the late 1940's, a Provisional Edition was produced, which updated the 1:10,560 mapping from a number of sources. The maps appear unfinished - with all military camps and other strategic sites removed. These maps were initially overprinted with the National Grid. In 1970, the first 1:10,000 maps were produced using the Transverse Mercator Projection. The revision process continued until recently, with new editions appearing every 10 years or so for urban areas.

### Map Name(s) and Date(s)

014SW
1887
1:10,560
022NW
1888
1:10,560

### Historical Map - Slice A

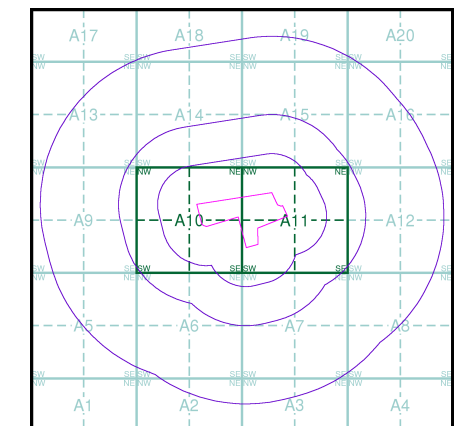

### Order Details

Order Number: 169911223\_1\_1  
Customer Ref: RCH080  
National Grid Reference: 522990, 413380  
Slice: A  
Site Area (Ha): 9.64  
Search Buffer (m): 1000

### Site Details

B O C Ltd, Hobson Way, Stallingborough, GRIMSBY, DN41 8DZ

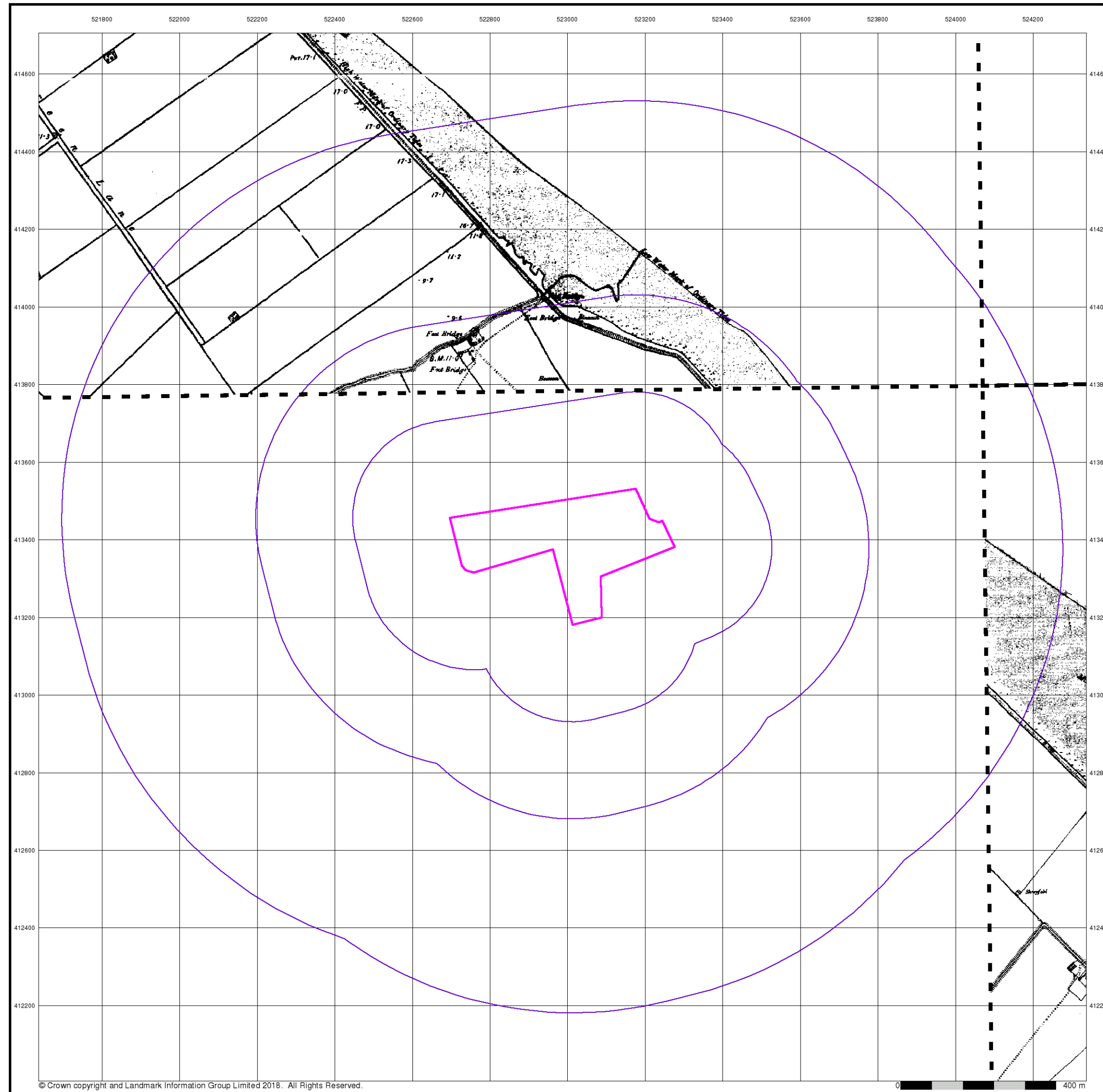

© Crown copyright and Landmark Information Group Limited 2018. All Rights Reserved.

## Yorkshire

### Published 1892

### Source map scale - 1:10,560

The historical maps shown were reproduced from maps predominantly held at the scale adopted for England, Wales and Scotland in the 1840's. In 1854 the 1:2,500 scale was adopted for mapping urban areas; these maps were used to update the 1:10,560 maps. The published date given therefore is often some years later than the surveyed date. Before 1938, all OS maps were based on the Cassini Projection, with independent surveys of a single county or group of counties, giving rise to significant inaccuracies in outlying areas. In the late 1940's, a Provisional Edition was produced, which updated the 1:10,560 mapping from a number of sources. The maps appear unfinished - with all military camps and other strategic sites removed. These maps were initially overprinted with the National Grid. In 1970, the first 1:10,000 maps were produced using the Transverse Mercator Projection. The revision process continued until recently, with new editions appearing every 10 years or so for urban areas.

### Map Name(s) and Date(s)

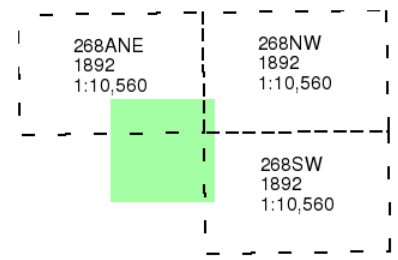

### Historical Map - Slice A

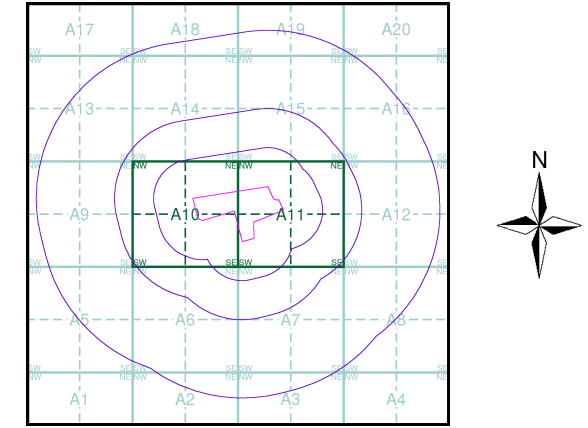

### Order Details

Order Number:	169911223_1_1
Customer Ref:	RCH080
National Grid Reference:	522990, 413380
Slice:	A
Site Area (Ha):	9.64
Search Buffer (m):	1000

### Site Details

B O C Ltd, Hobson Way, Stallingborough, GRIMSBY, DN41 8DZ



The historical maps shown were reproduced from maps predominantly held at the scale adopted for England, Wales and Scotland in the 1840's. In 1854 the 1:2,500 scale was adopted for mapping urban areas; these maps were used to update the 1:10,560 maps. The published date given therefore is often some years later than the surveyed date. Before 1938, all OS maps were based on the Cassini Projection, with independent surveys of a single county or group of counties, giving rise to significant inaccuracies in outlying areas. In the late 1940's, a Provisional Edition was produced, which updated the 1:10,560 mapping from a number of sources. The maps appear unfinished - with all military camps and other strategic sites removed. These maps were initially overprinted with the National Grid. In 1970, the first 1:10,000 maps were produced using the Transverse Mercator Projection. The revision process continued until recently, with new editions appearing every 10 years or so for urban areas.

### Map Name(s) and Date(s)

014SW
1908
1:10,560
022NW
1908
1:10,560

### Historical Map - Slice A

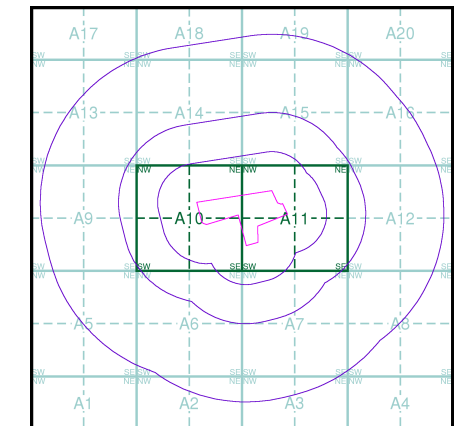

### Order Details

Order Number: 169911223\_1\_1  
Customer Ref: RCH080  
National Grid Reference: 522990, 413380  
Slice: A  
Site Area (Ha): 9.64  
Search Buffer (m): 1000

### Site Details

B O C Ltd, Hobson Way, Stallingborough, GRIMSBY, DN41 8DZ

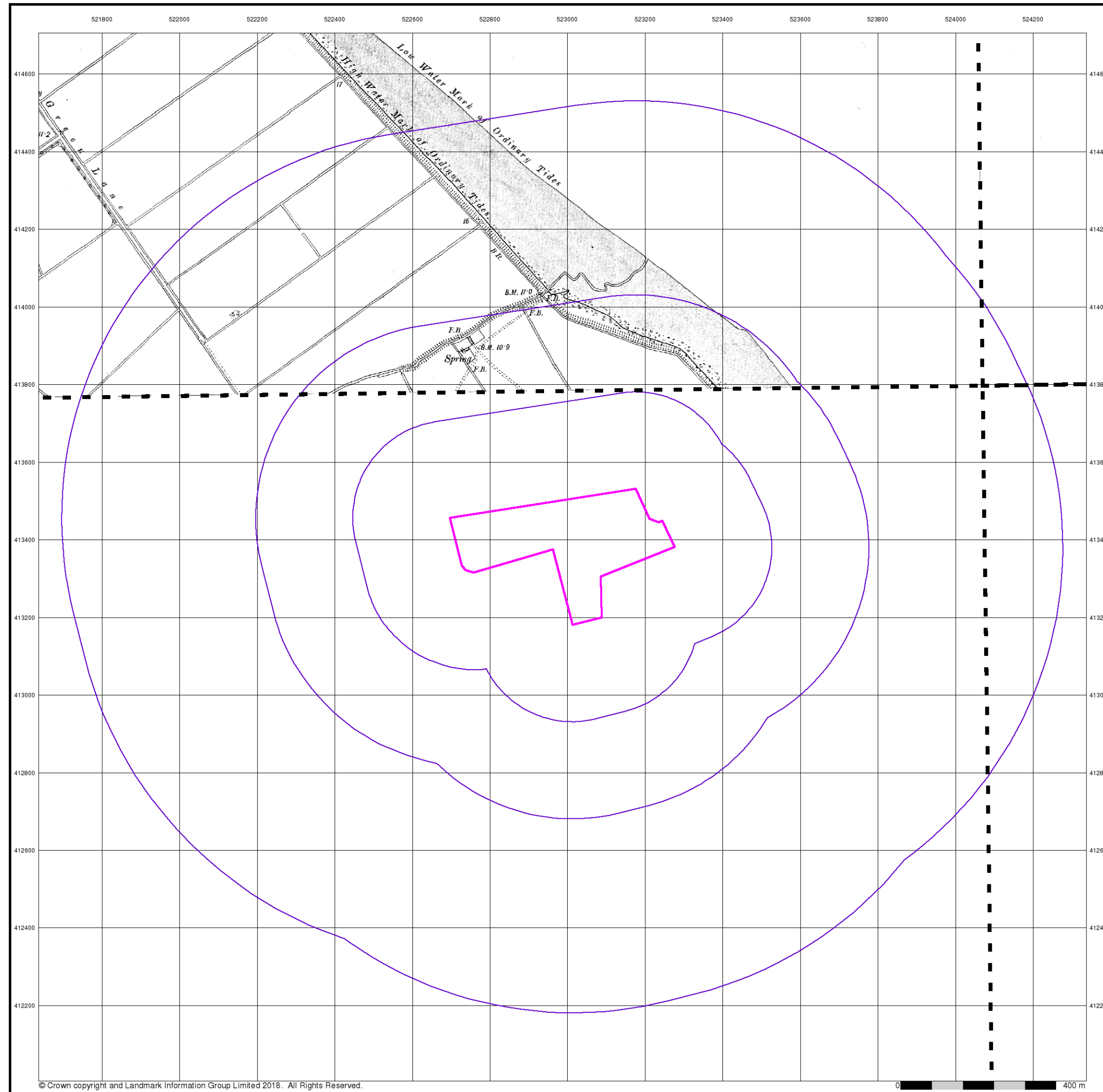

## Yorkshire

Published 1910

Source map scale - 1:10,560

The historical maps shown were reproduced from maps predominantly held at the scale adopted for England, Wales and Scotland in the 1840's. In 1854 the 1:2,500 scale was adopted for mapping urban areas; these maps were used to update the 1:10,560 maps. The published date given therefore is often some years later than the surveyed date. Before 1938, all OS maps were based on the Cassini Projection, with independent surveys of a single county or group of counties, giving rise to significant inaccuracies in outlying areas. In the late 1940's, a Provisional Edition was produced, which updated the 1:10,560 mapping from a number of sources. The maps appear unfinished - with all military camps and other strategic sites removed. These maps were initially overprinted with the National Grid. In 1970, the first 1:10,000 maps were produced using the Transverse Mercator Projection. The revision process continued until recently, with new editions appearing every 10 years or so for urban areas.

### Map Name(s) and Date(s)

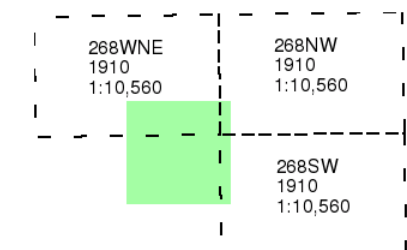

### Historical Map - Slice A

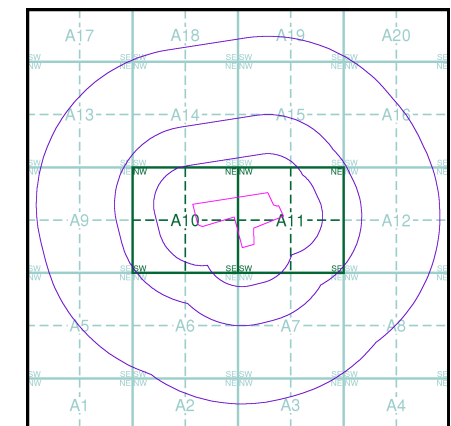

### Order Details

Order Number: 169911223\_1\_1  
Customer Ref: RCH080  
National Grid Reference: 522990, 413380  
Slice: A  
Site Area (Ha): 9.64  
Search Buffer (m): 1000

### Site Details

B O C Ltd, Hobson Way, Stallingborough, GRIMSBY, DN41 8DZ

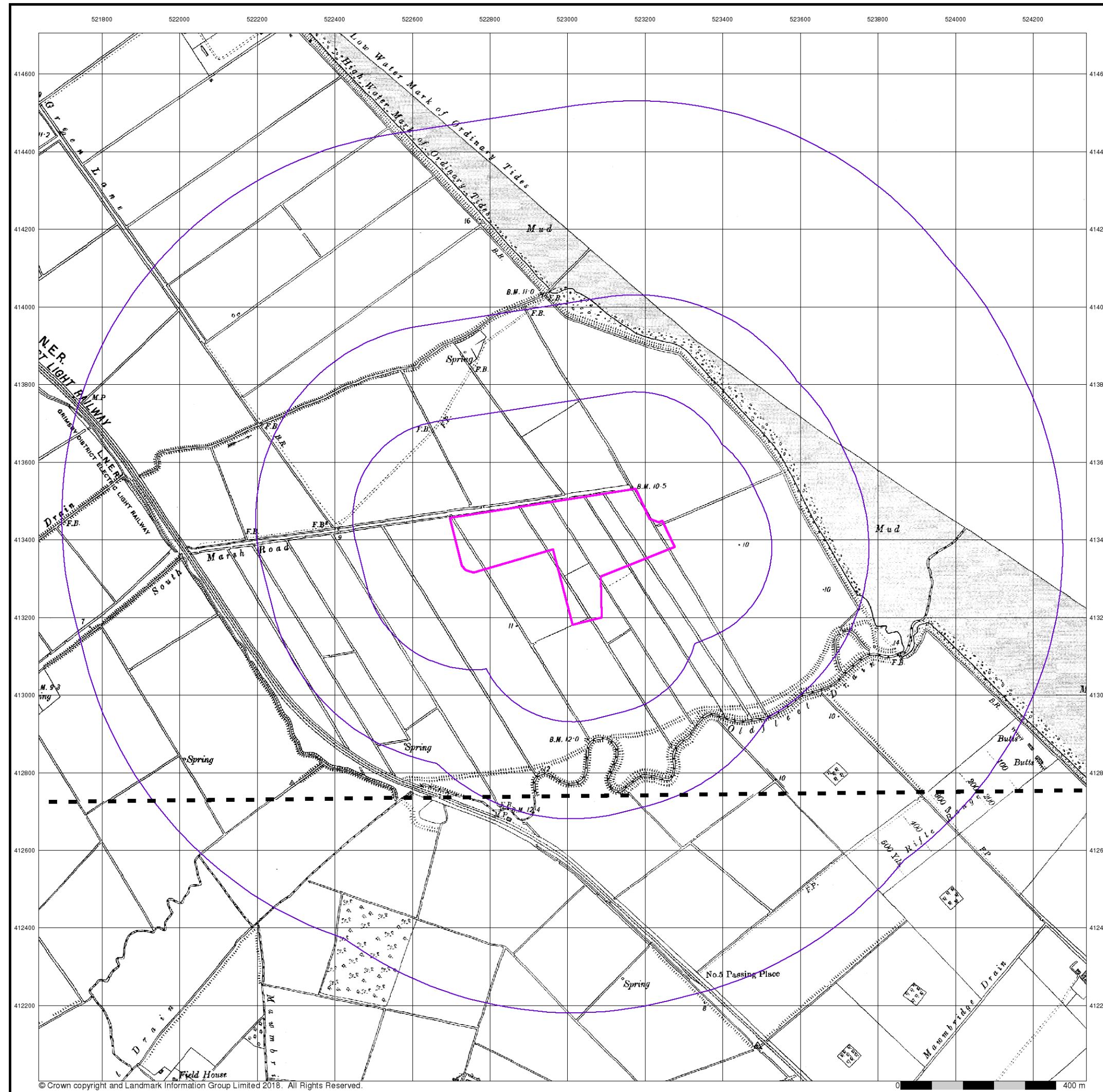

## Lincolnshire

Published 1932 - 1933

Source map scale - 1:10,560

The historical maps shown were reproduced from maps predominantly held at the scale adopted for England, Wales and Scotland in the 1840's. In 1854 the 1:2,500 scale was adopted for mapping urban areas; these maps were used to update the 1:10,560 maps. The published date given therefore is often some years later than the surveyed date. Before 1938, all OS maps were based on the Cassini Projection, with independent surveys of a single county or group of counties, giving rise to significant inaccuracies in outlying areas. In the late 1940's, a Provisional Edition was produced, which updated the 1:10,560 mapping from a number of sources. The maps appear unfinished - with all military camps and other strategic sites removed. These maps were initially overprinted with the National Grid. In 1970, the first 1:10,000 maps were produced using the Transverse Mercator Projection. The revision process continued until recently, with new editions appearing every 10 years or so for urban areas.

### Map Name(s) and Date(s)

014SW
1932
1:10,560
022NW
1933
1:10,560

### Historical Map - Slice A

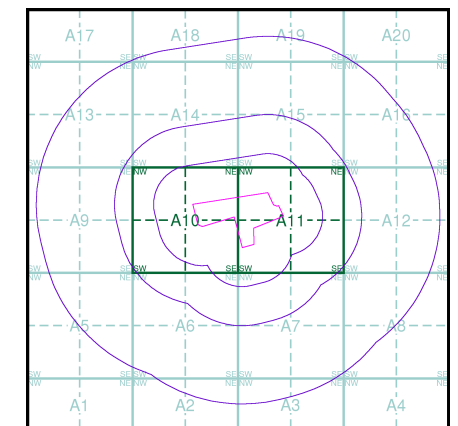

### Order Details

Order Number: 169911223\_1\_1  
Customer Ref: RCH080  
National Grid Reference: 522990, 413380  
Slice: A  
Site Area (Ha): 9.64  
Search Buffer (m): 1000

### Site Details

B O C Ltd, Hobson Way, Stallingborough, GRIMSBY, DN41 8DZ

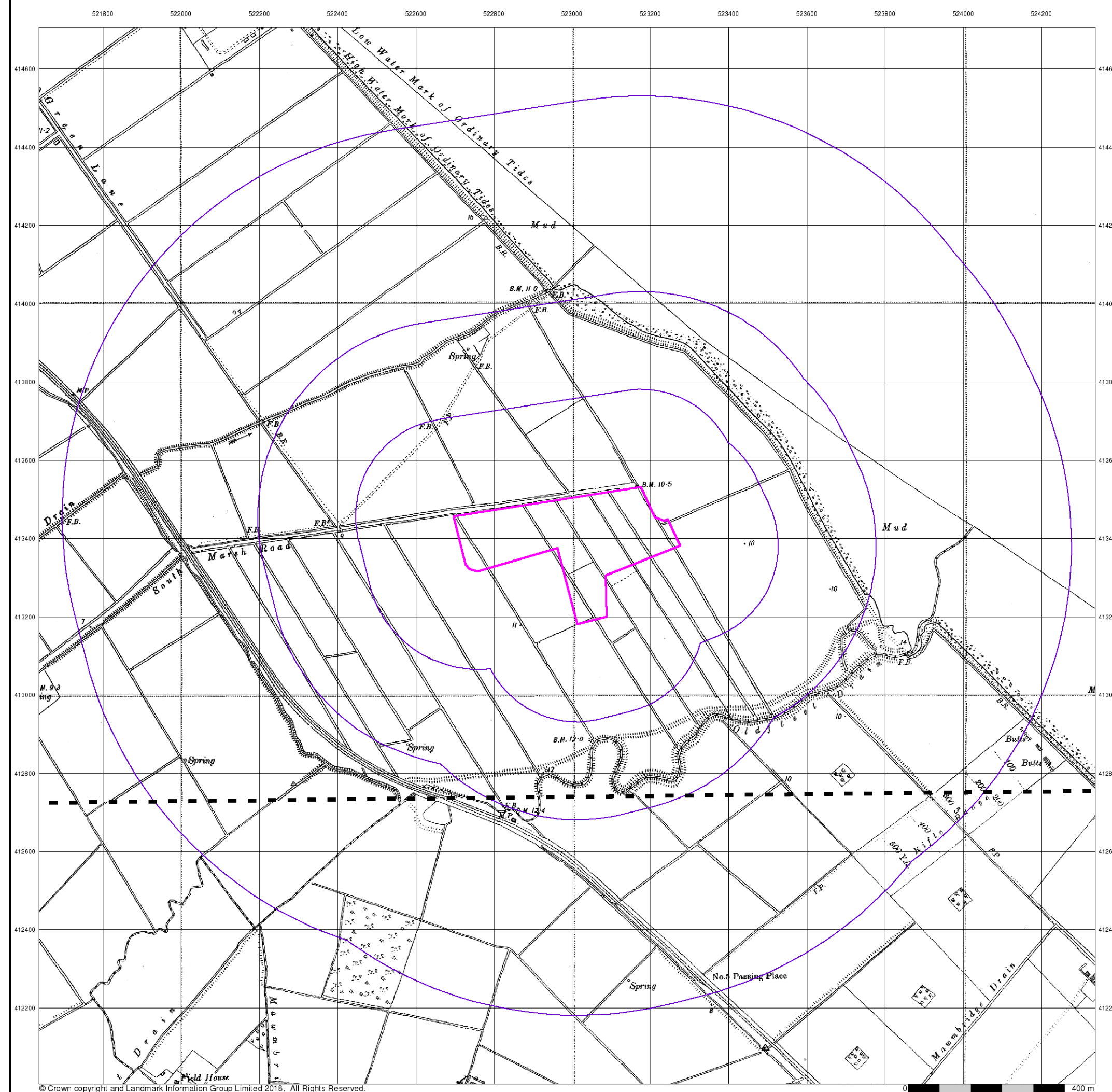

# Envirocheck®



LANDMARK INFORMATION GROUP®

## Lincolnshire

**Published 1938 - 1951**

**Source map scale - 1:10,560**

The historical maps shown were reproduced from maps predominantly held at the scale adopted for England, Wales and Scotland in the 1840's. In 1854 the 1:2,500 scale was adopted for mapping urban areas; these maps were used to update the 1:10,560 maps. The published date given therefore is often some years later than the surveyed date. Before 1938, all OS maps were based on the Cassini Projection, with independent surveys of a single county or group of counties, giving rise to significant inaccuracies in outlying areas. In the late 1940's, a Provisional Edition was produced, which updated the 1:10,560 mapping from a number of sources. The maps appear unfinished - with all military camps and other strategic sites removed. These maps were initially overprinted with the National Grid. In 1970, the first 1:10,000 maps were produced using the Transverse Mercator Projection. The revision process continued until recently, with new editions appearing every 10 years or so for urban areas.

## Map Name(s) and Date(s)

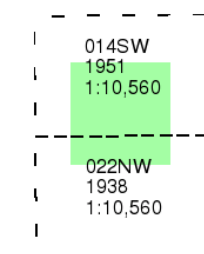

### Historical Map - Slice A

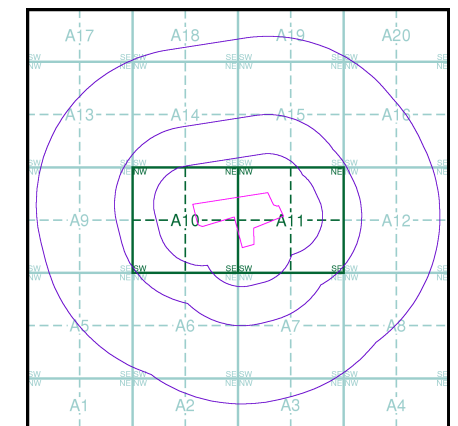

## Order Details

Order Number: 169911223\_1\_1  
Customer Ref: RCH080  
National Grid Reference: 522990, 413380  
Slice: A  
Site Area (Ha): 9.64  
Search Buffer (m): 1000

## Site Details

B O C Ltd, Hobson Way, Stallingborough, GRIMSBY, DN41 8DZ

**Landmark®**  
INFORMATION GROUP

Tel: 0844 844 9952  
Fax: 0844 844 9951  
Web: [www.envirocheck.co.uk](http://www.envirocheck.co.uk)

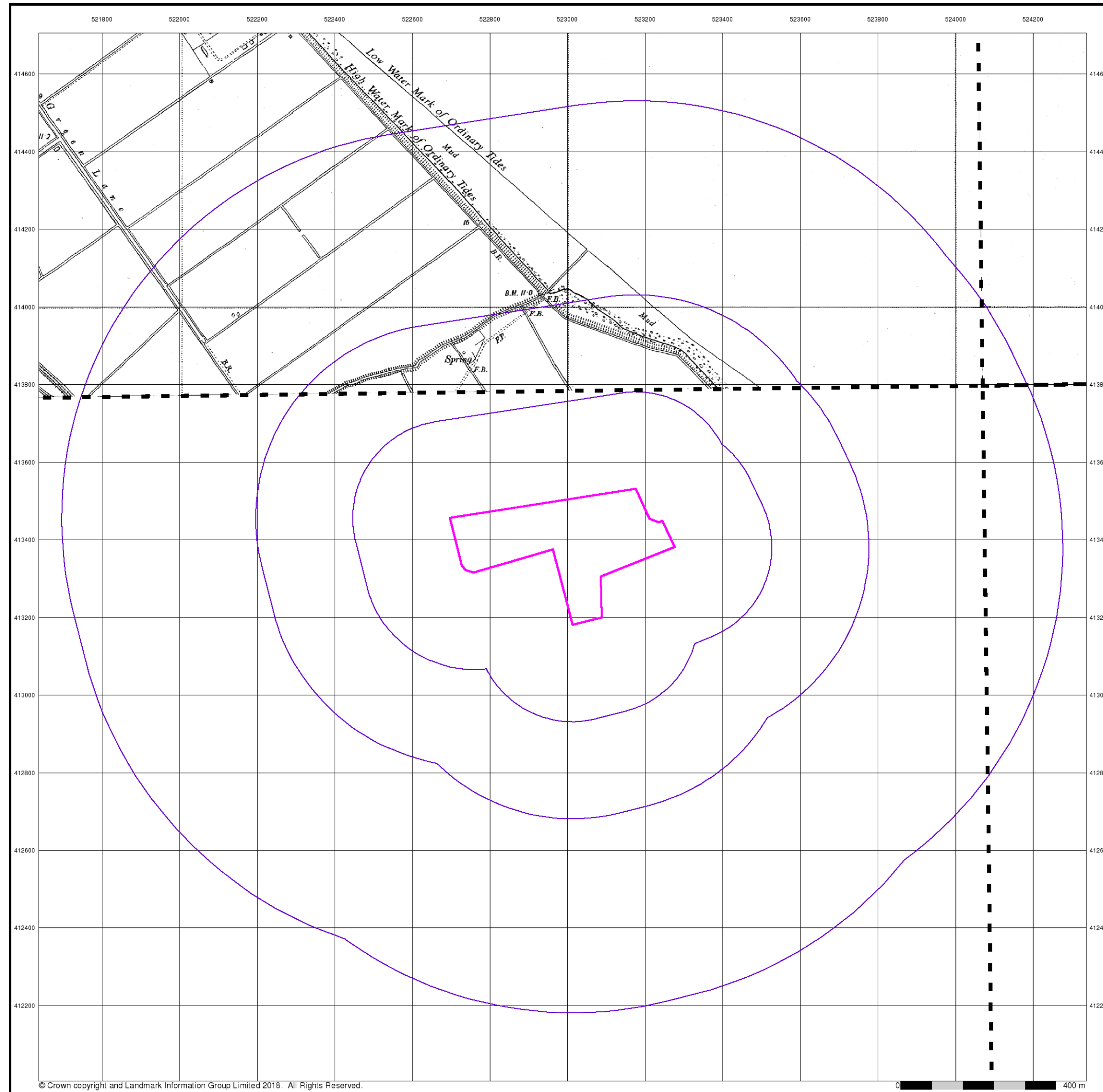

© Crown copyright and Landmark Information Group Limited 2018. All Rights Reserved.

## Yorkshire

Published 1951

Source map scale - 1:10,560

The historical maps shown were reproduced from maps predominantly held at the scale adopted for England, Wales and Scotland in the 1840's. In 1854 the 1:2,500 scale was adopted for mapping urban areas; these maps were used to update the 1:10,560 maps. The published date given therefore is often some years later than the surveyed date. Before 1938, all OS maps were based on the Cassini Projection, with independent surveys of a single county or group of counties, giving rise to significant inaccuracies in outlying areas. In the late 1940's, a Provisional Edition was produced, which updated the 1:10,560 mapping from a number of sources. The maps appear unfinished - with all military camps and other strategic sites removed. These maps were initially overprinted with the National Grid. In 1970, the first 1:10,000 maps were produced using the Transverse Mercator Projection. The revision process continued until recently, with new editions appearing every 10 years or so for urban areas.

### Map Name(s) and Date(s)

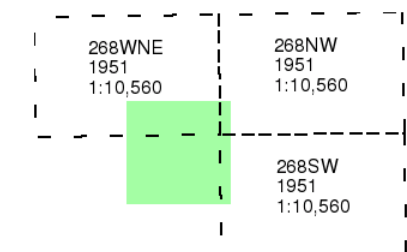

### Historical Map - Slice A

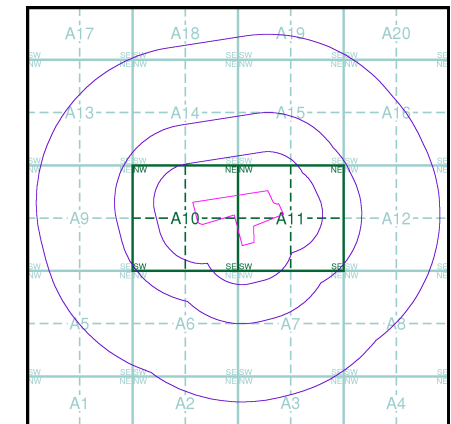

### Order Details

Order Number: 169911223\_1\_1  
Customer Ref: RCH080  
National Grid Reference: 522990, 413380  
Slice: A  
Site Area (Ha): 9.64  
Search Buffer (m): 1000

### Site Details

B O C Ltd, Hobson Way, Stallingborough, GRIMSBY, DN41 8DZ

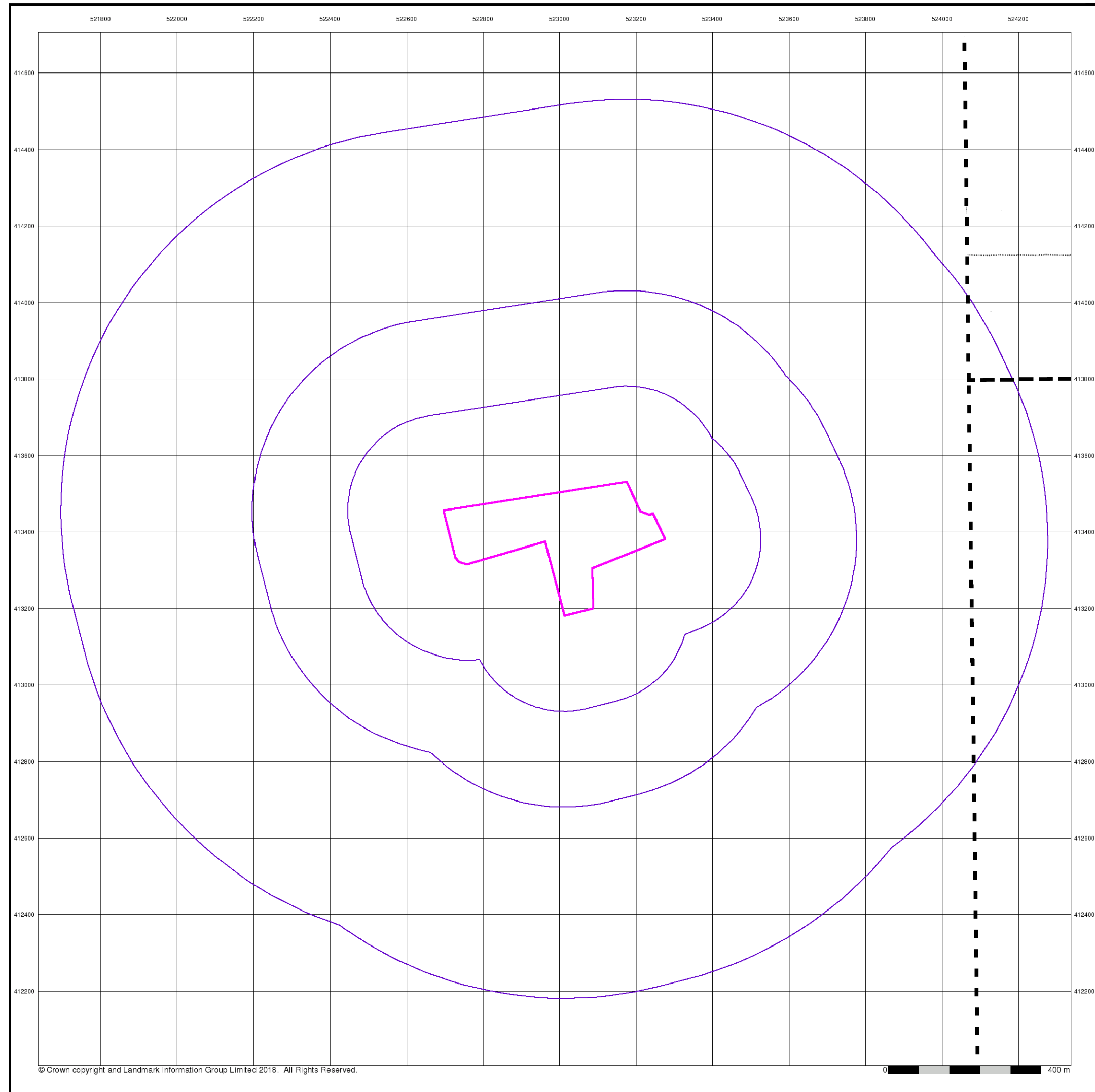

© Crown copyright and Landmark Information Group Limited 2018. All Rights Reserved.

0 400 m

# Envirocheck®

LANDMARK INFORMATION GROUP®

Yorkshire

Published 1951

Source map scale - 1:10,560

The historical maps shown were reproduced from maps predominantly held at the scale adopted for England, Wales and Scotland in the 1840's. In 1854 the 1:2,500 scale was adopted for mapping urban areas; these maps were used to update the 1:10,560 maps. The published date given therefore is often some years later than the surveyed date. Before 1938, all OS maps were based on the Cassini Projection, with independent surveys of a single county or group of counties, giving rise to significant inaccuracies in outlying areas. In the late 1940's, a Provisional Edition was produced, which updated the 1:10,560 mapping from a number of sources. The maps appear unfinished - with all military camps and other strategic sites removed. These maps were initially overprinted with the National Grid. In 1970, the first 1:10,000 maps were produced using the Transverse Mercator Projection. The revision process continued until recently, with new editions appearing every 10 years or so for urban areas.

## Map Name(s) and Date(s)

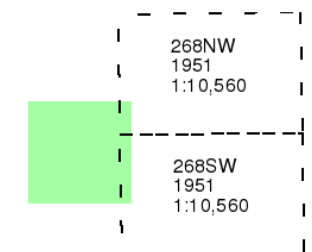

## Historical Map - Slice A

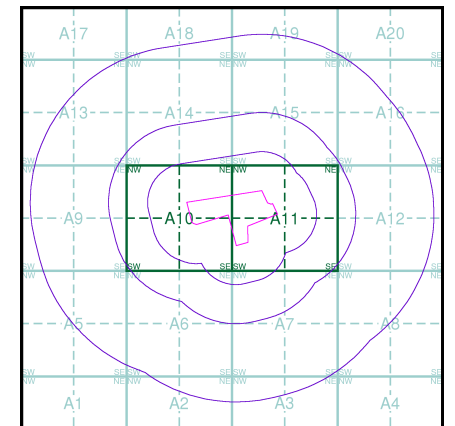

## Order Details

Order Number: 169911223\_1\_1  
Customer Ref: RCH080  
National Grid Reference: 522990, 413380  
Slice: A  
Site Area (Ha): 9.64  
Search Buffer (m): 1000

## Site Details

B O C Ltd, Hobson Way, Stallingborough, GRIMSBY, DN41 8DZ

Landmark®  
INFORMATION GROUP

Tel: 0844 844 9952  
Fax: 0844 844 9951  
Web: www.envirocheck.co.uk

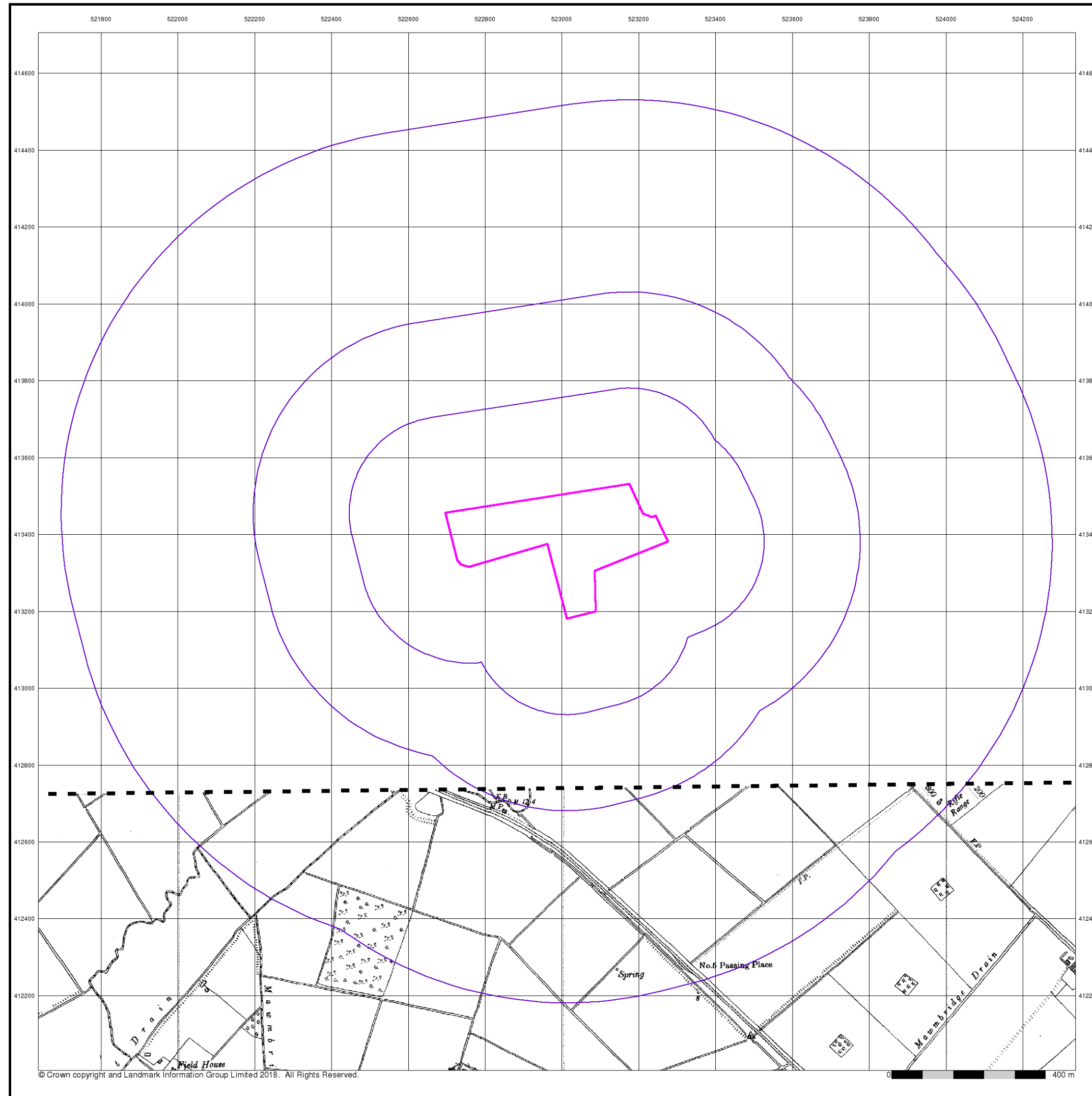

Lincolnshire

Published 1951

Source map scale - 1:10,560

The historical maps shown were reproduced from maps predominantly held at the scale adopted for England, Wales and Scotland in the 1840's. In 1854 the 1:2,500 scale was adopted for mapping urban areas; these maps were used to update the 1:10,560 maps. The published date given therefore is often some years later than the surveyed date. Before 1938, all OS maps were based on the Cassini Projection, with independent surveys of a single county or group of counties, giving rise to significant inaccuracies in outlying areas. In the late 1940's, a Provisional Edition was produced, which updated the 1:10,560 mapping from a number of sources. The maps appear unfinished - with all military camps and other strategic sites removed. These maps were initially overprinted with the National Grid. In 1970, the first 1:10,000 maps were produced using the Transverse Mercator Projection. The revision process continued until recently, with new editions appearing every 10 years or so for urban areas.

Map Name(s) and Date(s)

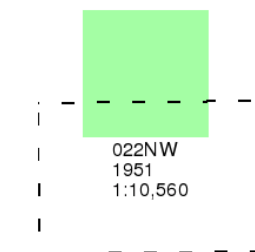

Historical Map - Slice A

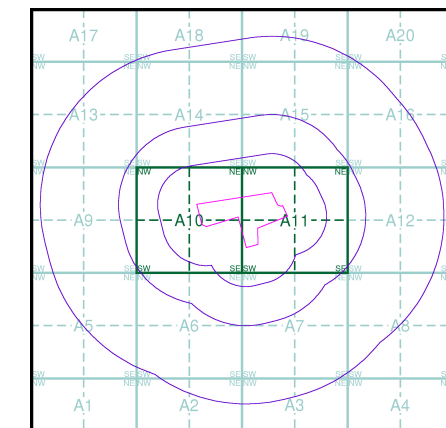

Order Details

Order Number:	169911223_1_1
Customer Ref:	RCH080
National Grid Reference:	522990, 413380
Slice:	A
Site Area (Ha):	9.64
Search Buffer (m):	1000

Site Details

B O C Ltd, Hobson Way, Stallingborough, GRIMSBY, DN41 8DZ



## Ordnance Survey Plan

Published 1956

Source map scale - 1:10,000

The historical maps shown were reproduced from maps predominantly held at the scale adopted for England, Wales and Scotland in the 1840's. In 1854 the 1:2,500 scale was adopted for mapping urban areas; these maps were used to update the 1:10,560 maps. The published date given therefore is often some years later than the surveyed date. Before 1938, all OS maps were based on the Cassini Projection, with independent surveys of a single county or group of counties, giving rise to significant inaccuracies in outlying areas. In the late 1940's, a Provisional Edition was produced, which updated the 1:10,560 mapping from a number of sources. The maps appear unfinished - with all military camps and other strategic sites removed. These maps were initially overprinted with the National Grid. In 1970, the first 1:10,000 maps were produced using the Transverse Mercator Projection. The revision process continued until recently, with new editions appearing every 10 years or so for urban areas.

## Map Name(s) and Date(s)

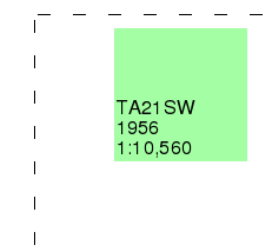

## Historical Map - Slice A

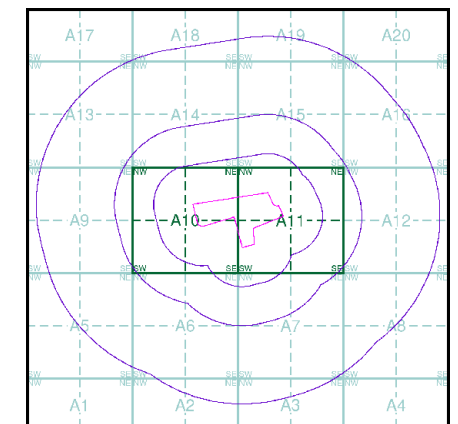

## Order Details

Order Number: 169911223\_1\_1  
Customer Ref: RCH080  
National Grid Reference: 522990, 413380  
Slice: A  
Site Area (Ha): 9.64  
Search Buffer (m): 1000

## Site Details

B O C Ltd, Hobson Way, Stallingborough, GRIMSBY, DN41 8DZ